

## Technical data sheet of the product:

### The metal device is protective, anti-vandal - MDPA-1.1

**Attention:** Before using the product, read the operating information below. This manual contains basic instructions that must be followed during installation, operation and maintenance of the product.

#### 1. APPOINTMENT

The <sup>TM</sup> ARMA DETECT protection device is produced of AISI 304 (A2) metal, stainless steel. It is used for mechanical protection of notifier devices - wireless alarm button / smart button, which can be found on the official website of the manufacturer.

#### 2. TECHNICAL SPECIFICATION

All parts of the device are made of chemically resistant stainless steel metal in accordance with TY Y 25.7-29326917482-001:202 and meet the technical requirements in force on the territory of Ukraine. Ukrainian Classifier of Goods (YKT 3EД) – 8302 (Fixing fittings, fittings and similar products from base metals).

Installation kit:

Decorative screw 1, fixing ring 2 in the amount of	- 4 pcs,
Sleeve 4	- 4 pcs,
Screw 5 in the amount of	- 4 pcs,
Plastic dowel 6 in the amount of	- 4 pcs,
Sticker-template for marking holes	- 1 pcs,

The installation kit ensures reliable mounting of the panic button protection on the base (wall, floor and ceiling). It is used for fixing the protective reinforced plate to the surface. The product will help to strengthen the protection against external interference and vandalism in the correct operation of the button, and will make it impossible to quickly dismantle it from the place of previous installation. Thanks to the mounting kit, the cover plate will be securely attached to the required surface.

#### 3. PRODUCT IMAGE

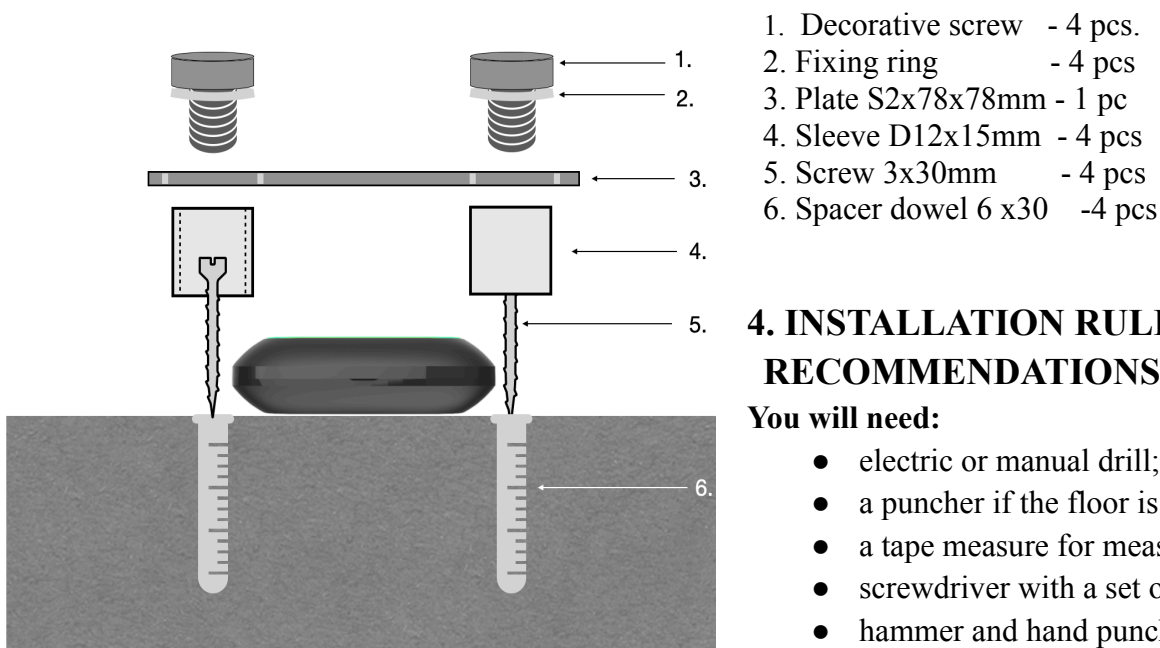

1. Decorative screw - 4 pcs.
2. Fixing ring - 4 pcs
3. Plate S2x78x78mm - 1 pc
4. Sleeve D12x15mm - 4 pcs
5. Screw 3x30mm - 4 pcs
6. Spacer dowel 6 x30 -4 pcs

#### 4. INSTALLATION RULES AND RECOMMENDATIONS

**You will need:**

- electric or manual drill;
- a puncher if the floor is concrete;
- a tape measure for measuring the distance;
- screwdriver with a set of bits;
- hammer and hand punch;
- 6x110 SDS drill bit for a perforator drill

**Install the protection on the surface as follows:**

- mark the location of the four holes using the sticker from the kit;
- drill holes with a drill that correspond to the dimensions of the sticker;
- install the dowels in the holes previously cleaned of crumbs/dust;
- install the sleeves first, fix them with screws. Install the plate on the bushings and screw in the decorative screws.

**Additional recommendations:**

- Drill bit oscillation at the beginning of drilling can be eliminated by punching a small hole with a light punch.
- To prevent the floor from crumbling, reduce the diameter of the drill bit. And in the case of ceramic tiles, use a drill bit for ceramics/glass.
- The depth of the holes is controlled by a mark on the drill bit.

**5. OPERATING REQUIREMENTS**

Before starting operation, be sure to check the integrity of all structural elements, fasteners (screws) and decorative caps. If necessary, you should ensure the presence of these elements yourself.

The operating temperature of the product is from: - 35° to + 65°C.

However, it should be noted that the operating temperature of the panic button is from -10° to +40°C.

**6. WARRANTY**

The warranty period for the product is two years from the date of manufacture.

The standard service life of the product in interaction with the environment is at least 20 years.

The warranty covers any product defects caused by manufacturing and material defects.

The terms of the warranty card do not apply to logistics services (return/exchange of goods).

The warranty does not cover product defects in the following cases:

1. The warranty card is lost or replaced.
2. The date of sale is missing.
3. The equipment was damaged during transportation from the place of purchase to the place of installation.
4. In case the consumer has changed the product configuration.
5. Use of the product in violation of the operating requirements.
6. Mechanical damage to the products during transportation, as a result of impact or falling, or the use of force;
7. Exposure to low or high temperatures not specified in the operating instructions;
8. Incorrect installation of the product.
9. In case of damage (deformation, subsidence) of the installation site.
10. In case of paint application. Aggressive liquids on the surface of the product.

**Procedure for reviewing complaints**

1. Claims for visible (visual) damage are considered within two weeks from the date of sale.
2. The buyer must fill out a complaint report and send a photo or video of the defect to the mail: info@armadetect.com.
3. Consideration and decision on the complaint is made within seven business days.

**7. WARRANTY CARD**

Vendor.....

Date of sale.....